

TCXO 7050 SMD

Features:

- Low Power Consumption
- High Stability
- Mass production with good uniformity
- ISO9001:2008 & ISO 14001:2004 certificated
- ROHS compliant
- Custom build capability

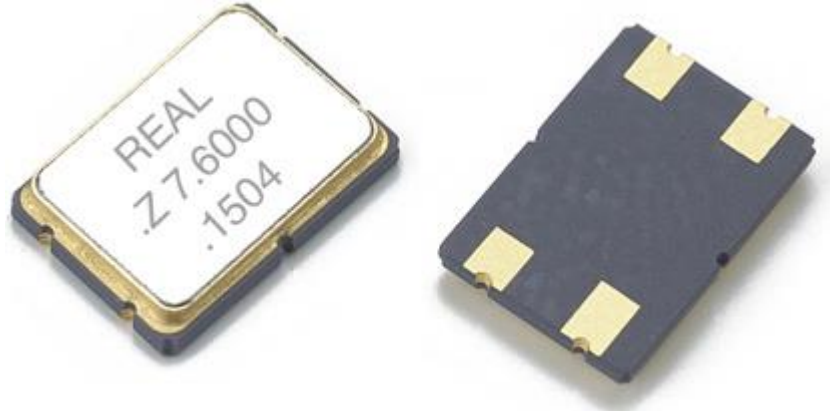

Specification:

Parameter	Min	Typ.	Max	Unit	Condition	Note
Frequency Stability						
Frequency	10.0		50.0	MHz		
Initial Frequency Accuracy	-0.5ppm /-1ppm		+0.5ppm /+1pp	ppm	Vc=1.65V/ @25°C,after 15mins power on ref to nominal frequency.	
Supply Variation	-0.2		+0.2	ppm	Vcc±5%, @25°C	
Load Variation	-0.2		+0.2	ppm	CL±5%, @25°C	
Aging	per day	-1	+1	ppm	Aging after 30 days of operation	For 10.000MHz operational frequency
	10 years	-5	+5	ppm		
Temperature Stability	-0.28/-1		+0.28/+1	ppm	-40°C~+85°C @ 25°C	
Supply Voltage/Current						
Voltage Supply	3.135	3.3	3.465	V		
	4.75	5	5.25			
Operating Current			10	mA		
			30	mA		
Output Characteristics						
CMOS	Load		15	30	pF	
	Output Level(VOL)			10%Vcc	V	
	Output Level(VOH)	90%Vcc			V	
	Duty Cycle	45		55	%	
	Rise Time/ Fall Time			5	ns	
Clipped Sine	Load		10K/10P		Ω	
	Level	0.8V			Vpp	
	Harmonics Level					

* Above specification subject to change without prior notice, please consult our sales @ www.crystal-bj.com



北京瑞安嘉业科技发展有限公司

REALGIANT BEIJING REALGIANT TECHNOLOGY CO., LTD

Phase Noise						
Phase Noise		-85		dBc/H z	@10Hz	For 10.000MHz operational frequency
		-110			@100Hz	
		-130			@1kHz	
		-145			@10KHz	
		-145			@100KHz	
		-148			@1MHz	
Voltage Control Characteristics						
Control Voltage Range	0	1.65	3.3	V		
	0	2.5	5			
Frequency tuning range	-9		-15	ppm	Vc=0V	For 10.000MHz operational frequency
	-1		+1	ppm	Vc=1.65V	
	+9		+15	ppm	Vc=3.3V	
Slope	Positive					
Linearity	-10		+10	%		
Input Impedance	100			KΩ		
Mechanical specification & Package						
Package Size	Refer to the below drawing					
Pin Connector Size						
Pin Connector Definition						
ROHS	RoHS compliant (network exempted)					

Environmental, Mechanical Conditions	
Operating temp range	-40°C~+85°C
Operable temp range	-40°C~+85°C
Storage temp range	-50°C~+105°C
Drop Test	The test shall be carried out as the provisions of the IEC60028-2-32 test Ed. 10cm height, 3 times on hard board with thickness of 3cm
Bumping Test	Device are bumped to three mutually perpendicular axes at peak acceleration of 400m/s ² , each 4000±10 times , 6ms pulse duration time.
Vibration test	Frequency range: 1Hz-4Hz-100Hz-200Hz Acceleration: 0.0001g ² /Hz-0.01g ² /Hz-0.01g ² /Hz-0.001g ² /Hz Grms=1.15g Sweep time: 30 minutes (perpendicular axes each sweep time)
Mechanical Shock	100g, 6mS duration, 1/2 sine wave, 3 shocks each direction along 3 mutually perpendicular planes.
Thermal shock	0.5h@-40°C , 0.5h@+85°C , Note: the changing time < 30 seconds, cycling for 100 times

* Above specification subject to change without prior notice, please consult our sales @ www.crystal-bj.com

Dimensions:

Unit : mm

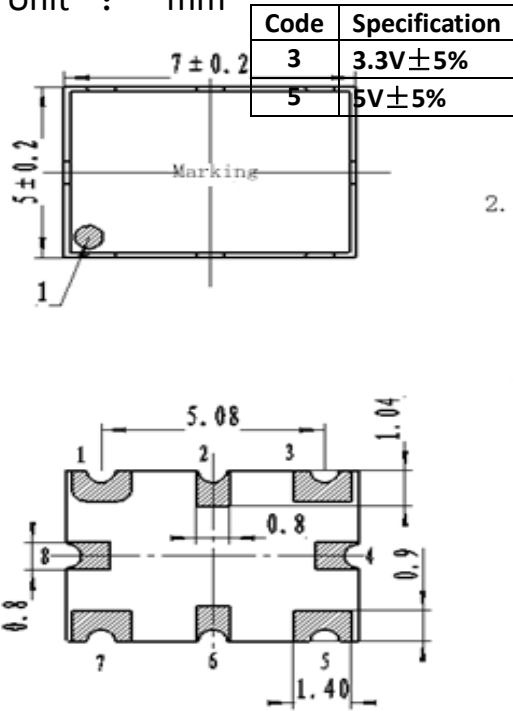

Pin Function:

Pin No.	Pin Function
1	VC
2	NC
3	GND
4	NC
5	OUTPUT
6	NC
7	VCC
8	NC

Note: Pin 2,4,6,8 are NC, there is no electrical connection.

How to Order

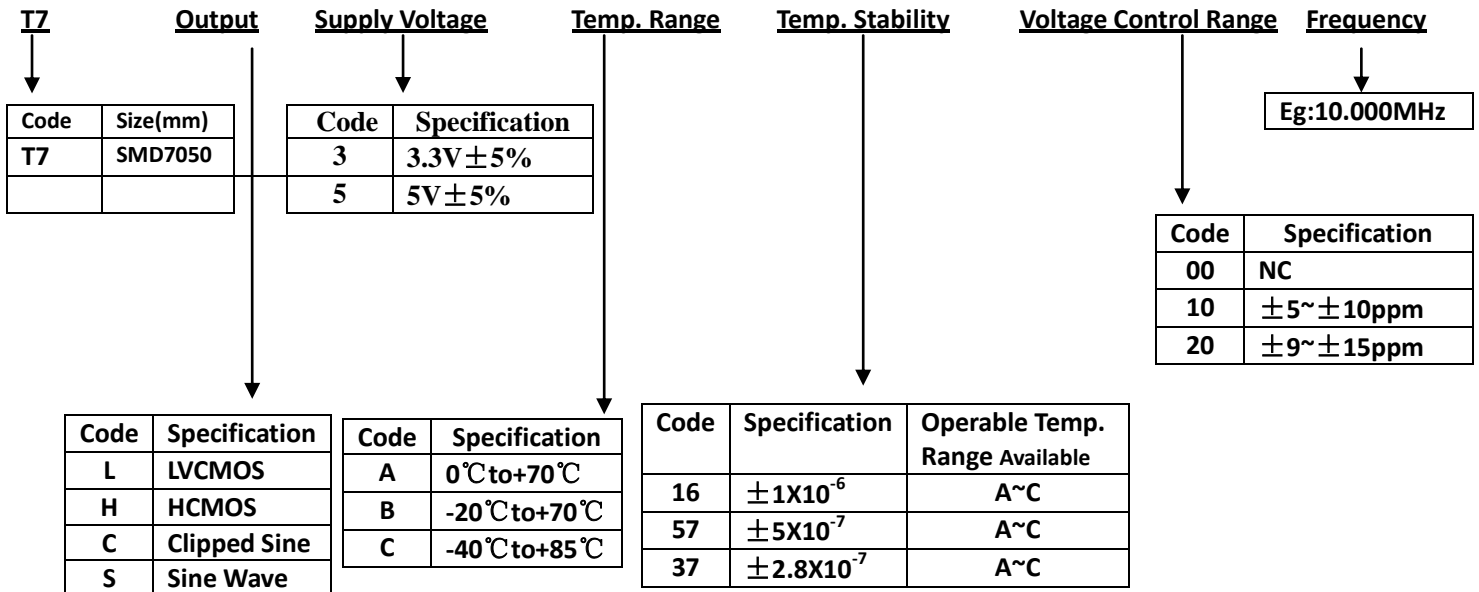

* Above specification subject to change without prior notice, please consult our sales @ www.crystal-bj.com